

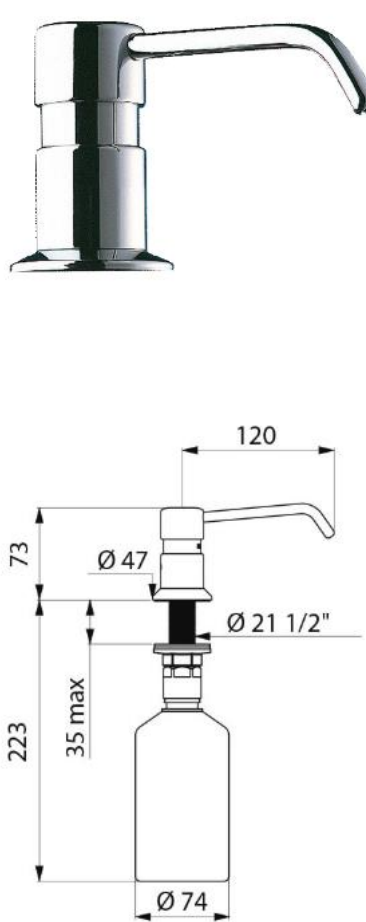





PROJECT		REF		REV	ITEM CODE	
LOCATION		DATE			PAGE	

SANITARY WARE SPECIFICATION SHEET

<p>Item Descriptions</p> <p>Model</p> <p>Material/ Finish</p> <p>Manufacturer</p> <p>Source</p> <p>Contact Tel/Fax</p> <p>E-mail</p> <p>Website</p>	<p>Delabie (France) Deck-mounted liquid soap or hydroalcoholic gel dispenser</p> <p>729512</p> <p>Brass / Chrome Plated</p> <p>Delabie (France)</p> <p>Acme Sanitary Ware Co. Ltd Mr. Eric Wong/ Mr. Don Yuen</p> <p>(852) 2388-7171 / (852) 2710-8012 acme@acmesanitary.com.hk www.acmesanitary.com.hk</p>	<p>Illustration/ Drawing</p>  <p>ADVANTAGES</p> <ul style="list-style-type: none">  Vandal-resistant model  Suitable for intensive use  Easy to fill  Liquid soap or hydroalcoholic gel 								
<p>DESCRIPTION</p> <p>Liquid soap dispenser, 0.5-litre - Ref. 729512</p> <p>Deck-mounted soap dispenser with curved spout. Liquid soap or hydroalcoholic gel dispenser. Model for installing on washbasins. Vandal-resistant model. Chrome-plated brass body and push-button. Non-drip system (waterproof). Mechanism can be locked via a grub screw. Top fill (by unscrewing the push-button) or from the lower part (by unscrewing the bottle). Supplied with a 0.5-litre bottle. Compatible with hydroalcoholic gel.</p> <p>TECHNICAL CHARACTERISTICS</p> <p>Liquid soap dispenser, 0.5-litre - Ref. 729512</p> <table border="1"> <tr> <td>Height</td> <td>73mm, beneath the basin 223mm</td> </tr> <tr> <td>Spout length</td> <td>120mm</td> </tr> <tr> <td>Volume</td> <td>0.5-litre tank</td> </tr> <tr> <td>Finish</td> <td>Chrome-plated brass body and push-button</td> </tr> </table>		Height	73mm, beneath the basin 223mm	Spout length	120mm	Volume	0.5-litre tank	Finish	Chrome-plated brass body and push-button	
Height	73mm, beneath the basin 223mm									
Spout length	120mm									
Volume	0.5-litre tank									
Finish	Chrome-plated brass body and push-button									

Note:

* All information of the above is for the reference only. No prior notice is made if any changes.

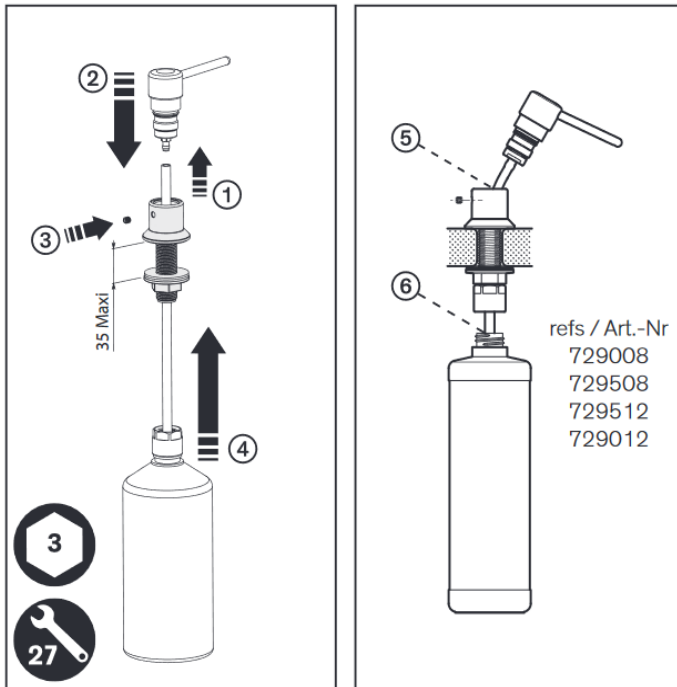

REFILLING (fig. D)

- From the top by removing the dispenser head ⑤.
- Into the reservoir by unscrewing it from the dispenser ⑥.

FEATURES

EN

- Pump-action liquid soap dispenser (the mechanism operates by suction).
- The pump mechanism can be removed for maintenance or for refilling. The upper part can be locked in place by a grub screw using a 3 mm Allen key, which is supplied in a separate bag.

INSTALLATION (fig. C)

- Fit the tube over the mechanism's nozzle ①.
- Slide the tube and mechanism into the sheath ②.
- Insert the screw ③ and then tighten the bottle underneath ④.

INSTALLATION

- **ATTENTION: Do not use soapy water, detergents and acidic soaps with a pH less than 6.**
- Only use liquid soaps.
- Press the push-button slowly several times to evacuate the air out of the tube.
- To avoid a long priming time for references 729150, 729112 & 729108, position the 5L soap reservoir at a maximum distance of 600mm from the dispenser on a dedicated shelf (fig. A).

NB: The non-return valve should not touch the bottom of the tank.

Note: To avoid priming the dispenser after every refill, top-up the soap in the reservoir before it is completely empty.

MAINTENANCE & CLEANING

Cleaning chrome: do not use abrasive, chlorine or any other acid-based cleaning products. Clean with mild soapy water using a cloth or a sponge.

Clean the pump with hot water.